

QG3364

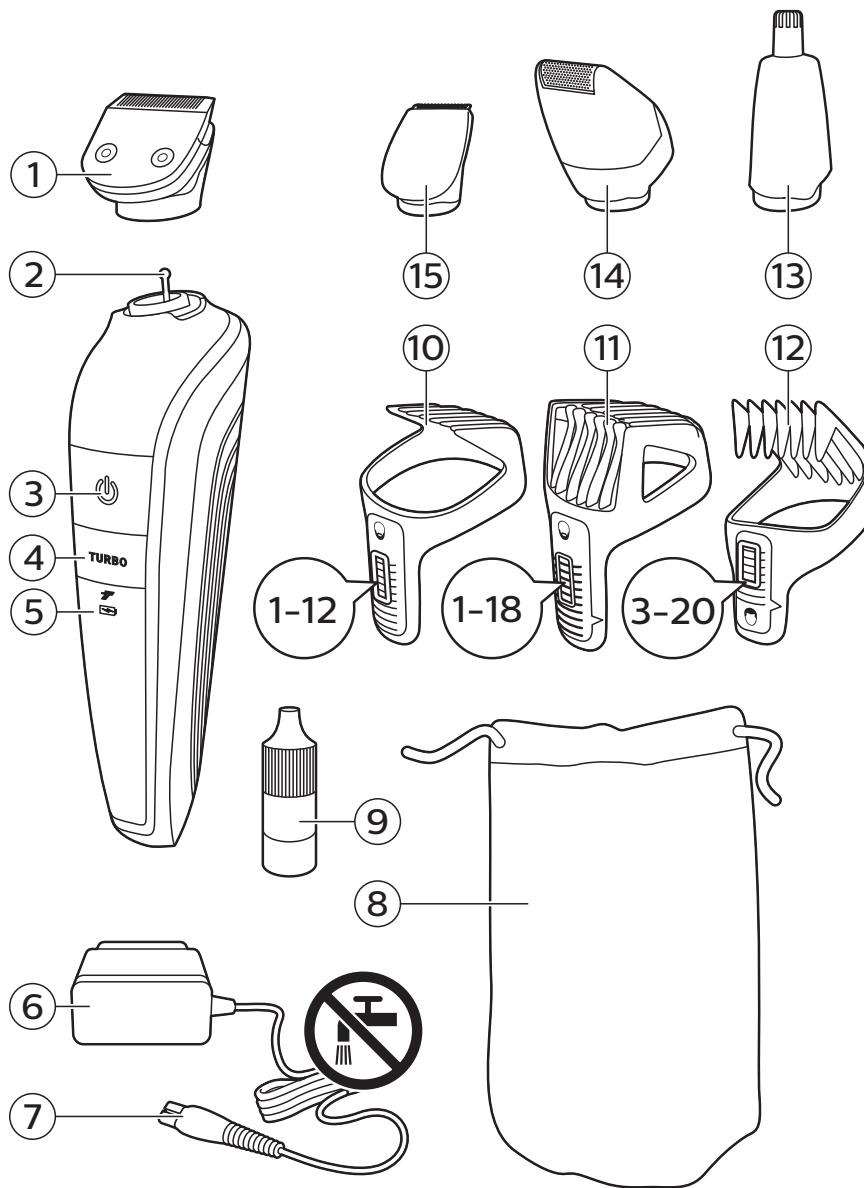

**PHILIPS**



## Introduction

Congratulations on your purchase and welcome to Philips! To fully benefit from the support that Philips offers, register your product at [www.philips.com/welcome](http://www.philips.com/welcome).

## General description (Fig.1)

- 1 Full-size trimmer
- 2 Attachment connector
- 3 On/off button
- 4 Turbo button
- 5 Battery status indicator
- 6 Adapter
- 7 Small plug
- 8 Pouch
- 9 Oil bottle
- 10 Dedicated stubble comb (32mm)
- 11 Beard and stubble comb (32mm)
- 12 Hair comb (32mm)
- 13 Nose trimmer rotary
- 14 Detail foil shaver
- 15 Detail trimmer (21mm)

## Important safety information

Read this important information carefully before you use the appliance and its accessories and save it for future reference. The accessories supplied may vary for different products.

### **Danger**

- Keep the adapter dry (Fig. 2).

### **Warning**

- The adapter contains a transformer. Do not cut off the adapter to replace it with another plug, as this causes a hazardous situation.
- This appliance is not intended for use by persons (including children) with reduced physical, sensory or mental capabilities, or lack of experience and knowledge, unless they have been given supervision or instruction concerning use of the appliance by a person responsible for their safety.

- Children should be supervised to ensure that they do not play with the appliance.
- Always unplug the appliance before you clean it under the tap.
- Always check the appliance before you use it. Do not use the appliance if it is damaged, as this may cause injury. Always replace a damaged part with one of the original type.
- Do not open the appliance to replace the rechargeable battery.

### **Caution**

- Never immerse the appliance in water. Do not use the appliance in the bath or shower.
- Never use water hotter than 80°C to rinse the appliance.
- Only use this appliance for its intended purpose as shown in the user manual.
- For hygienic reasons, the appliance should only be used by one person.
- Do not use the adapter in or near wall sockets that contain or have contained an electric air freshener to prevent irreparable damage to the adapter.
- Never use compressed air, scouring pads, abrasive cleaning agents or aggressive liquids such as petrol or acetone to clean the appliance.

### **Electromagnetic fields (EMF)**

- This Philips appliance complies with all applicable standards and regulations regarding exposure to electromagnetic fields.

### **General**

- This appliance can be safely cleaned under the tap (Fig. 3).
- The appliance is suitable for mains voltages ranging from 100 to 240 volts.
- The adapter transforms 100-240 volts to a safe low voltage of less than 24 volts.

### **Charging**

Charge the appliance before you use it for the first time and when the display indicates that the battery is almost empty.

It takes approximately 1 hour to fully charge the appliance.

When the appliance is fully charged, it has an operating time of up to 60 minutes.

*Note: This appliance can be used without cord or directly from the mains.*

- 1 Switch off the appliance.
- 2 Insert the small plug into the appliance and put the adapter in the wall socket (Fig. 4).

### **Battery low**

When the battery status indicator flashes orange, the battery is running low.

### **Battery charging**

The battery status indicator flashes green to indicate that the appliance is charging.

### **Battery full**

The battery status indicator lights up continuously to indicate that the appliance is fully charged.

## **Using the appliance**

Warning: Always check the appliance before you use it. Do not use the appliance if it is damaged, as this may cause injury. Always replace a damaged part with one of the original type.

*Note: This appliance can be used without cord or directly from the mains.*

### **Detaching and attaching cutting elements**

- 1 To detach a cutting element, turn it anti-clockwise and pull it upwards off the handle (Fig. 5).
- 2 To attach a cutting element, place it on the handle and turn it clockwise (Fig. 6).

### **Detaching and attaching combs**

- 1 To detach any type of comb from the cutting element, press the length setting selector, grab the sides and pull it upwards off the cutting element (Fig. 7).
- 2 To attach any type of comb onto a cutting element, slide it into the guiding grooves on both sides of the handle (Fig. 8).

### **Switching the appliance on and off**

- 1 To switch on the appliance, press the on/off button once.
- 2 To switch off the appliance, press the on/off button once (Fig. 9).

### Turbo

The appliance is equipped with a turbo setting to help you trim through thick hair evenly. During grooming you can activate the turbo setting for fast results.

**Note:** *Only use the turbo setting with the full metal trimmer.*

- 1** To activate the turbo setting, press the Turbo button once (Fig. 10). The turbo indicator lights up blue.
- 2** To deactivate the turbo setting, press the Turbo button again.

### Precision attachments for use on face

#### Nose trimming

You can use the nose trimmer attachment to trim your nose hair and ear hair.

- Make sure your nostrils are clean. Make sure your outer ear channels are clean and free from wax.
- Do not insert the tip more than 0.5cm and make controlled movements.

#### Nose trimmer rotary

Trimming nose hair:

- Gently move the tip in and out of your nose while turning it round to remove unwanted hairs (Fig. 11).

Trimming ear hair:

- Slowly move the tip round the ear to remove hairs that stick out beyond the rim of the ear.
- Gently move the tip in and out of the outer ear channel to remove unwanted hairs (Fig. 12).

#### Detail trimmer (21mm)

You can use the detail trimmer without comb to create fine lines and contours around your facial style, close to the skin (Fig. 13) (to a length of 0.5mm).

#### Detail foil shaver

You can use the detail foil shaver to shave unwanted hairs on your cheeks and chin with precision. Gently press the detail foil shaver onto the skin and shave along contoured edges to remove any hairs (Fig. 14).

## **Attachments for use on beard**

- We advise you to start at the highest length setting to familiarize yourself with the appliance.
- Make controlled movements against the hair growth and move it over the part that needs trimming.

### **Full-size trimmer 32mm**

You can use the full-size metal trimmer without comb to get clean lines around your beard, neck and sideburns close to the skin (Fig. 15) (to a length of 0.5mm).

### **Beard and stubble comb**

You can use the beard and stubble comb attached to the full size trimmer to evenly trim your beard, stubble and moustache. You can choose any setting between 1 and 18mm in steps of 1mm (Fig. 16).

### **Dedicated stubble comb**

You can use the dedicated stubble comb attached to the full size trimmer to trim your stubbles. You can choose any length setting between 1 and 12mm (Fig. 17).

## **Attachments for use on head**

Hair clipping with comb

- Comb the hair in the growth direction.
- Slowly move the trimmer against the hair growth direction. Press lightly.
- Since hair grows in different directions, you need to move the appliance in different directions as well (upward, downward or across).
- Always make sure that the flat part of the comb is in full contact with the scalp to obtain an even result.
- When you trim for the first time, start at the highest length setting (20mm) to familiarise yourself with the appliance.

Hair clipping without comb:

- Be careful when you trim without comb because the trimmer removes every hair it touches.
- Before you start to contour the hairline around the ears, with any comb attachment, comb the hair ends over the ears.

- Tilt the appliance in such a way that only the edge of the trimmer touches the hair.
- Only cut the hair ends. The hairline should be close to the ear.
- To contour the neckline and sideburns, turn the appliance and make downward strokes.
- Move the appliance slowly and smoothly. Follow the natural hairline.

### **Full-size metal trimmer 32mm**

You can use the full-size metal trimmer without comb to clip hair very close to the skin (to a length of 0.5mm) or to create contours around your ears or neck (Fig. 18).

### **Hair comb**

You can use the hair comb attached to the full size trimmer for an even haircut. You can choose any setting between 3 and 20mm in steps of 1mm (Fig. 19).

### **Cleaning and storage**

Never use scouring pads, abrasive cleaning agents or aggressive liquids such as petrol or acetone to clean the appliance.

Caution: Always switch off the appliance and disconnect it from the mains before cleaning.

Never dry the trimming teeth with a towel or tissue, as this may damage the trimming teeth.

- 1** Remove any comb or attachment from the appliance.
- 2** Blow and/or shake out any hair that has accumulated in the attachments and/or combs (Fig. 20).
- 3** Clean the attachments, the combs and the appliance under a lukewarm tap after every use (Fig. 21).
- 4** Carefully shake off excess water and let all parts dry.
- 5** Store the appliance and its attachments in the storage pouch to prevent damage.

*To maintain optimal trimming performance, lubricate the teeth of the full-size trimmer, the detail trimmer and the nose trimmer with a few drops of oil from the bottle supplied every three months and after cleaning (Fig. 22).*



## Cleaning shaving foils

The shaving foil is very delicate. Handle it carefully. Replace the shaving foil if it is damaged.

### Detail foil shaver

- 1** Pull the top part of the detail foil shaver off the bottom part. (Fig. 23)
- 2** Blow and/or shake out any hair that has accumulated inside the detail foil shaver. (Fig. 24)
- 3** Clean the top part of the detail foil shaver under a lukewarm tap (Fig. 25).
- 4** Apply a drop of oil from the bottle supplied to the foil of the detail foil shaver every three months or after cleaning (Fig. 26).

### Ordering accessories and replacement

To purchase accessories for this appliance, please visit our online shop at **[www.shop.philips.com/service](http://www.shop.philips.com/service)**. If the online shop is not available in your country, go to your Philips dealer or a Philips service centre. If you have any difficulties obtaining accessories for your appliance, please contact the Philips Consumer Care Centre in your country. You find its contact details in the worldwide guarantee leaflet.

### Disposal

This appliance contains a rechargeable battery which must be disposed of properly. Contact your local town or city officials for battery disposal information. You can also call 1-800-8-BATTERY or visit [www.rbrc.com](http://www.rbrc.com) for battery drop-off locations (Fig. 27).

For assistance, visit our website **[www.philips.com/support](http://www.philips.com/support)** or call 1-800-243-3050 toll free.

### Guarantee and support

If you need information or support, please **[www.philips.com/support](http://www.philips.com/support)** or call toll free: 1-866-800-9311. To locate the nearest Philips warranty depot, visit our website **[www.philips.com](http://www.philips.com)**.

### Guarantee restrictions

- Philips Consumer Lifestyle guarantees its products for a period of two years after the date of purchase. If any defect due to faulty materials or workmanship occurs within this two-year guarantee period, Philips Consumer Lifestyle will repair or replace the product at its expense.

- Philips Consumer Lifestyle will only pay for repair or replacement if convincing proof is provided, for instance by means of a receipt, that the day on which service is claimed is within the guarantee period. The shaving heads (cutters and shaving guards) are not covered by the terms of the international guarantee because they are subject to wear.
- The guarantee is not valid if a defect is due to damage caused by incorrect use, poor maintenance (e.g. parts blocked by scale) or if alterations or repairs have been carried out by persons not authorized by Philips Consumer Lifestyle.
- For the appliance to be used correctly, the user should strictly adhere to all instructions included in the user manual and should abstain from any actions or uses that are described as undesired or which are warned against in the user manual.
- These guarantee restrictions do not affect your statutory rights.

## Troubleshooting

This chapter summarizes the most common problems you could encounter with the appliance. If you are unable to solve the problem with the information below, visit **[www.philips.com/support](http://www.philips.com/support)** for a list of frequently asked questions or contact the Consumer Care Center in your country.

Problem	Possible cause	Solution
The combs do not stay attached to the handle	You did not attach the comb correctly.	Slide the comb into the guiding grooves on both sides of the appliance ('click').
	The guiding grooves are dirty.	Clean the appliance and the guiding grooves thoroughly.
	The comb is broken.	Go to your Philips dealer or contact a Philips service center to purchase a new comb.

Problem	Possible cause	Solution
The appliance does not work anymore.	The rechargeable battery is empty.	Charge the appliance (see chapter 'Charging'). Make sure you switch off the appliance before you charge it. During charging, the battery status indicator on the appliance flashes. If the battery status indicator does not flash, check whether there is a power failure or if the wall socket is live. If there is no power failure and the wall socket is live but the battery status indicator still does not flash, take the appliance to your dealer or a Philips service center.
The appliance does not charge when it is connected to the mains.	The appliance has to be switched off when you charge it.	Switch off the appliance.
The appliance does not trim as well as it used to.	The cutting element of the attachment you are using is dirty.	Remove the attachment from the appliance. Clean the attachment under a lukewarm tap.
		Make sure that the appliance is charged sufficiently.
The appliance becomes hot.	The cutting element of the attachment you are using is dirty.	Remove the attachment from the appliance. Clean the attachment under a lukewarm tap.

Problem	Possible cause	Solution
	The cutting element needs additional lubrication.	Lubricate the cutting element with a drop of oil from the bottle supplied with the appliance.

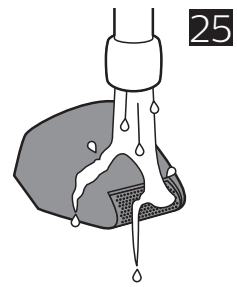
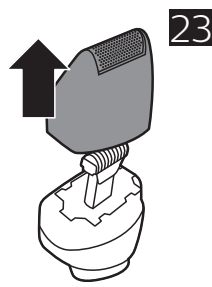
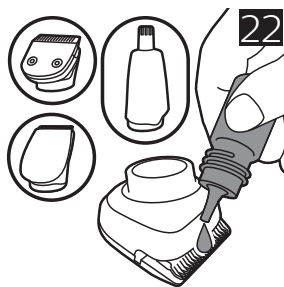
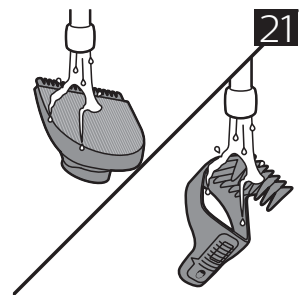
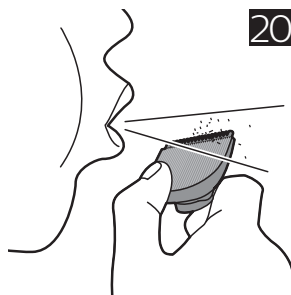
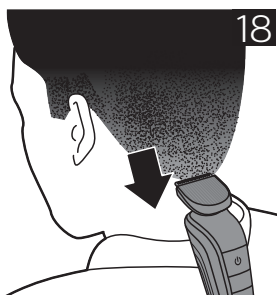
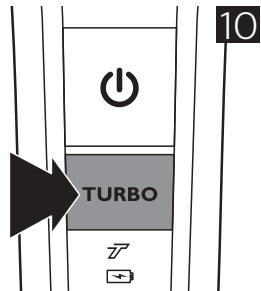
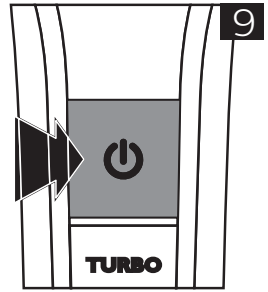
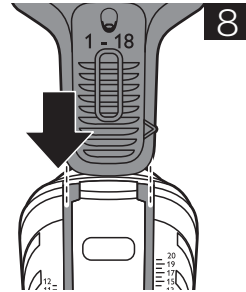
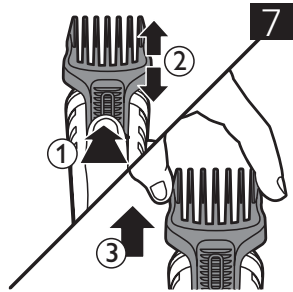
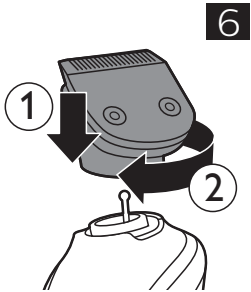
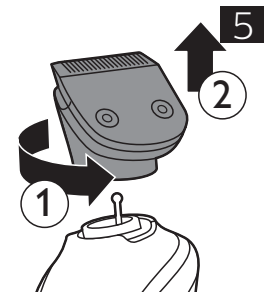
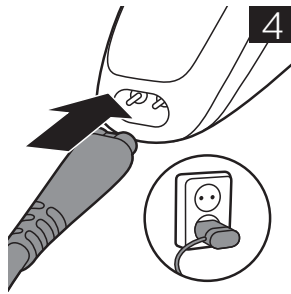
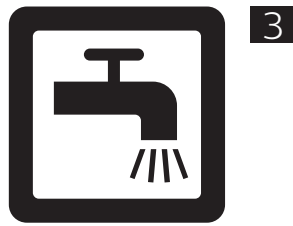



© 2015 Koninklijke Philips N.V.  
All rights reserved  
4222.002.8638.1 (11/2015)

